

mario cotta
Zincometal Group



GOLD



Replicability and *Objectivity*. These are the two drivers of **mario cotta** 's projects.

The **quality of the slitting process** is strictly related to the possibility to maintain the identical setting on every single Knife Holder on the slitting system. Excluding every **variable**, related to the **operator abilities** and to the **environment**, it's the only way to obtain the **perfect cut**.

Gold Pneumatic knife holder is the result of Mario Cotta's secular experience in engineering Slitting Systems.

50mm Minimum Cut, Drastic reduction of the Machine Downtime, High speed guaranteed with extreme slitting quality, maximum safety for operators. These are the achieved targets of Gold Pneumatic Knife Holder.

100% Proudly Made in Italy!

For major dimensions, please contact our office.

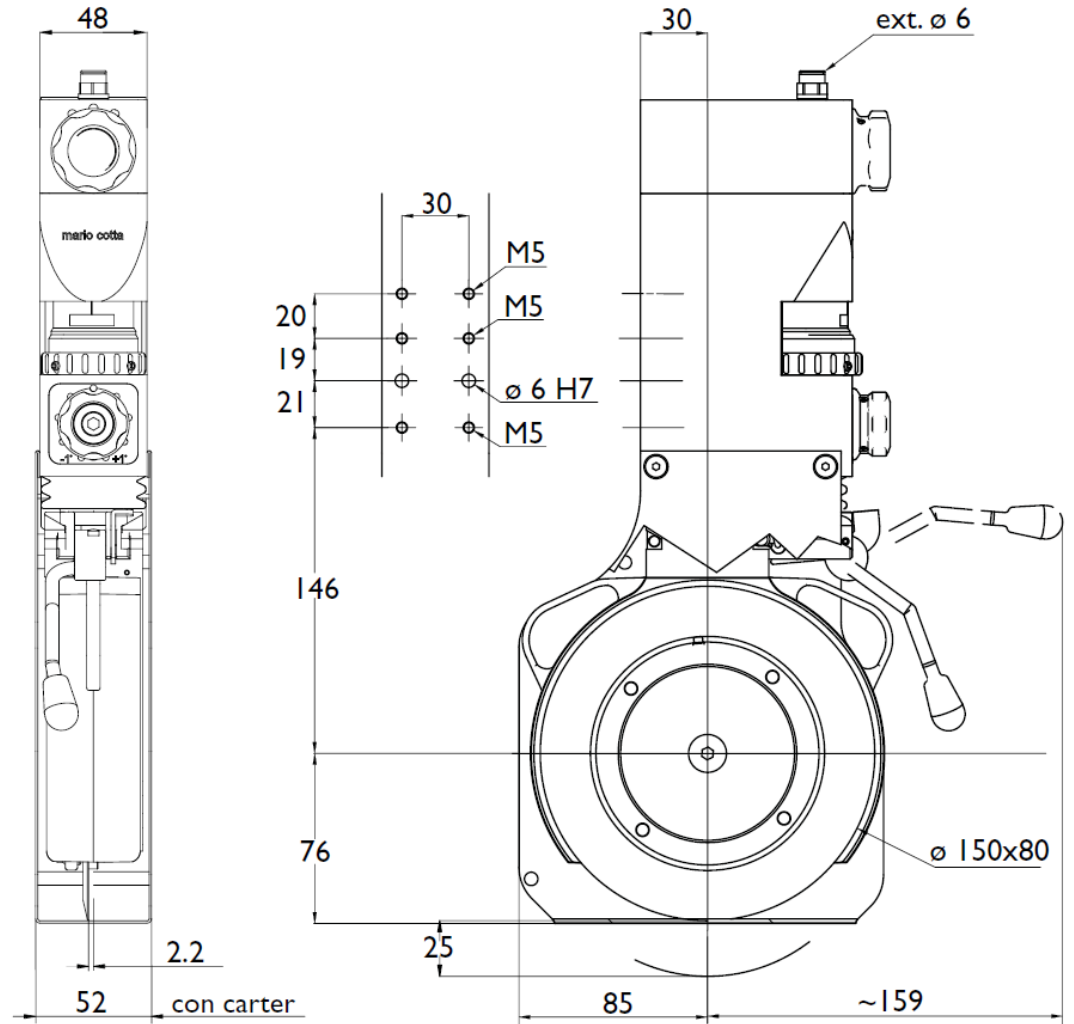

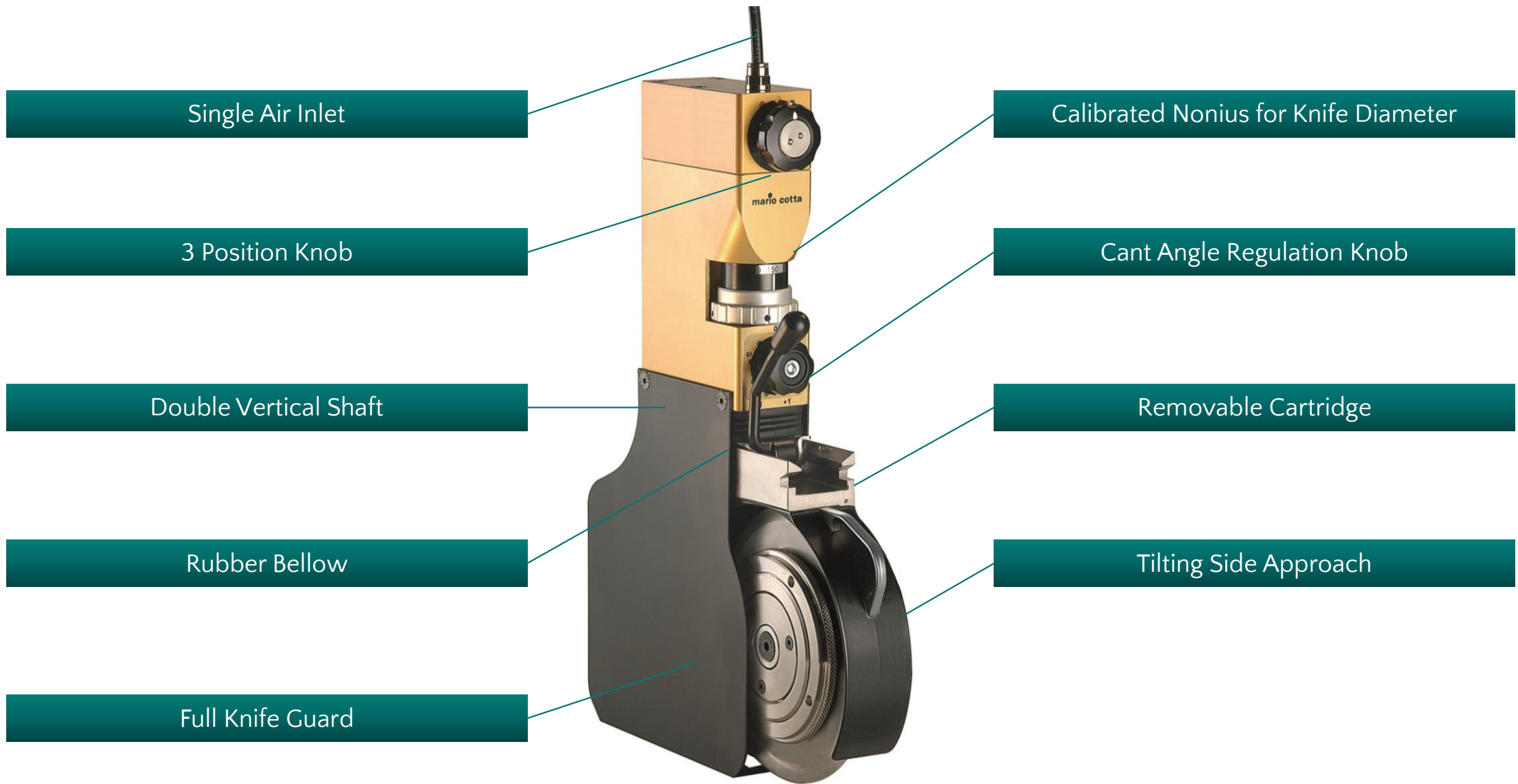

Gold Knife Holder

Three Position Knob



The knob allows an **easy** and **quick** setup of the Knife Holder thanks to the **Pneumatic Half Approach**.

Half Approach allows a quick and effective Knife Holder setup that **avoids** the **knife overlap** onto bottom knife and a **constant side load**.

Graduated Nonius



The Nonius allows a **replicable** and **objective regulation** of the knife **penetration** in order to maintain the most **effective** overlap also after changing or regrinding knives.

[Patented System](#)

Cant Angle



The Knob allows an **onboard cant angle regulation** without any special tools. Cant angle could be adjusted from **0°** to **±1°** with **0,25°** steps.

This system guarantees **Replicable** and **Objective** Adjustment on the entire slitting section.

[Patented System](#)

Single Air Inlet



Decreased setup time thanks to the automatic **Descent-Side Load / Side Unload-Ascent Cycle**.

Double Vertical Shaft

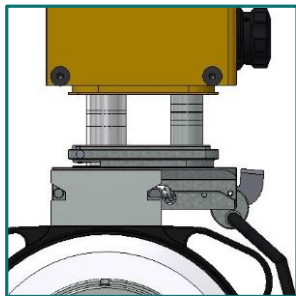

Two Chromed Steel Shafts for knife descent that ensure **absolute stability** during slitting process. Increased stability allows an **higher web speed** without losing slitting quality.

Rubber Bellow



The **Rubber Bellow** between the main body and the removable cartridge **avoids dust penetration** into the knife holder. This will grant same **performance** and **durability** during years.

360° Knife Guard*



The full **360° Knife Guard** allows to increase the **safety standards** for operators during those production's steps that present major operators' risk. Knife Guard increase the minimum slit width from 50mm to 52mm

Cartridge Knife Guard



The **Cartridge Guard** increase operators' safety during handling and Knife changing phases.

*Not Available for 130x80mm Blade

Main Features

Tilting Side Approach

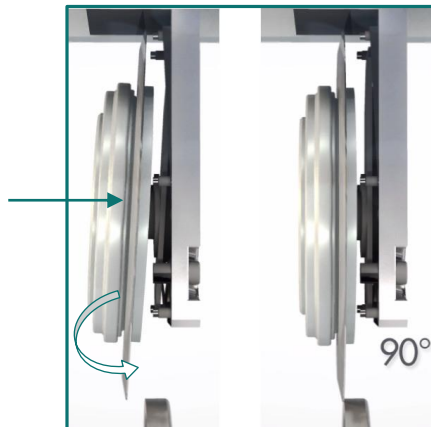

Tilting Side Approach allows to disengage the movement unit from rotation unit granting a drastic **reduction** of the **Run Out** and an **higher blades' average life**.

Furthermore, blade results always **centered** amongst knife holder, maintaining the minimum slitting width of **50mm** also **between left and right hands Knife Holders**.

Patented System

Removable Cartridge



The **Removable Cartridge** drastically **reduce** the machine **downtime** during knives change.

Moreover it allows to Operators to change knives in a **Safety and Controlled Environment**, increasing Operators' safety.

The Patented cartridge Dove Tail Rails permit **clearance during Cartridge insertion** – when needed – but once the lever is in close position, the rail guarantees the **perfect tightening**.

Dove Tail Rails are Patented

Characteristics & Optional

Characteristics

- ✓ 50mm minimum slit width, 52mm with Knife Guard
- ✓ Vertical Stroke 25 mm
- ✓ Horizontal Stroke 3,5 mm
- ✓ Separated Bracket
 - ✓ Dove Tail
 - ✓ Dove Tail with pinion
 - ✓ Linear with 1 ball-bearings carriers
 - ✓ Linear with 2 ball-bearings carriers

Optional

- ✓ Dust Suction Device
- ✓ Lubricator
- ✓ Score Cut Cartridge
- ✓ Razor Cut Cartridge

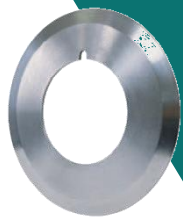

Standard Blades Compatibility

- 150x80 mm



On Demand Blades Compatibility

- 130x80 mm

Shear Cut Capability

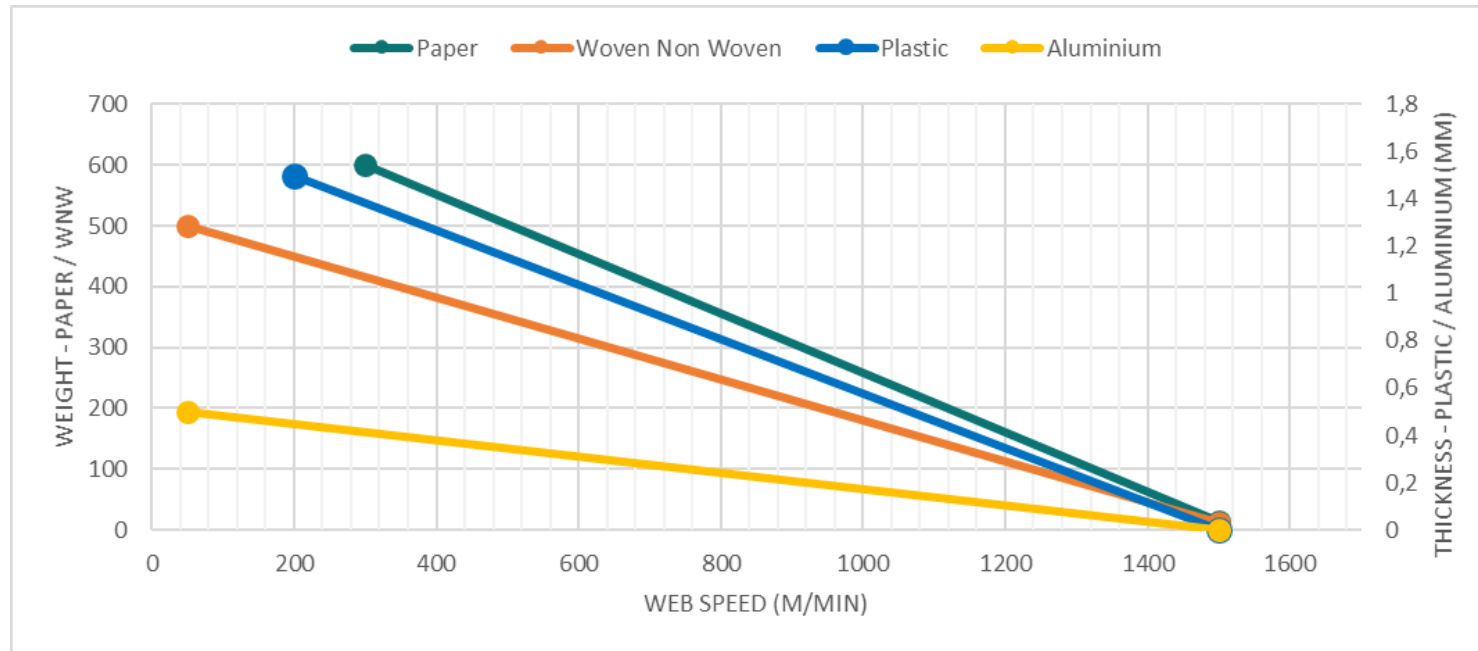

	Paper	Woven Non Woven	Flexible Plastic	Aluminium
Maximum Slitting Speed	Up to 1500 m/min with a slitting of 14 g/m ²	Up to 1500 m/min with a slitting of 11 g/m ²	Up to 1500 m/min with a slitting of 18 µm	Up to 1500 m/min with a slitting of 15 µm
Maximum Slitting Capability	Up to 600 g/m² with a speed of 300 m/min	Up to 500 g/m² with a speed of 50 m/min	Up to 1,5 mm with a speed of 200 m/min	Up to 0,5 mm with a speed of 50 m/min
Minimum Slitting Width	50 mm*	50 mm*	50 mm*	50 mm*

*52 mm with 360° Knife Guard

Slitting Capability – Load Graphs

Vertical Load

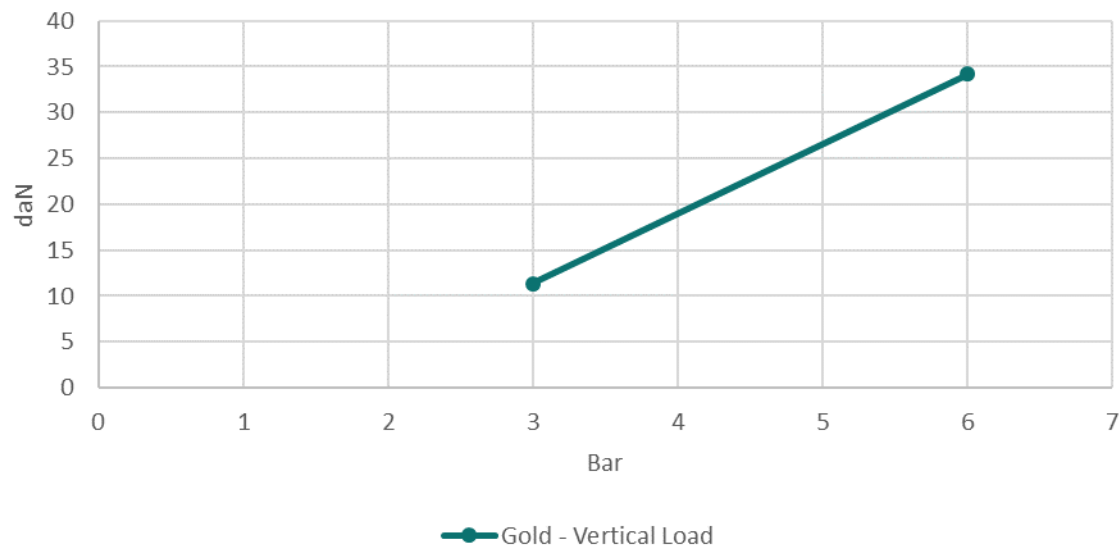

Vertical Load of 34 daN at 6 bar Pressure.

Side Load

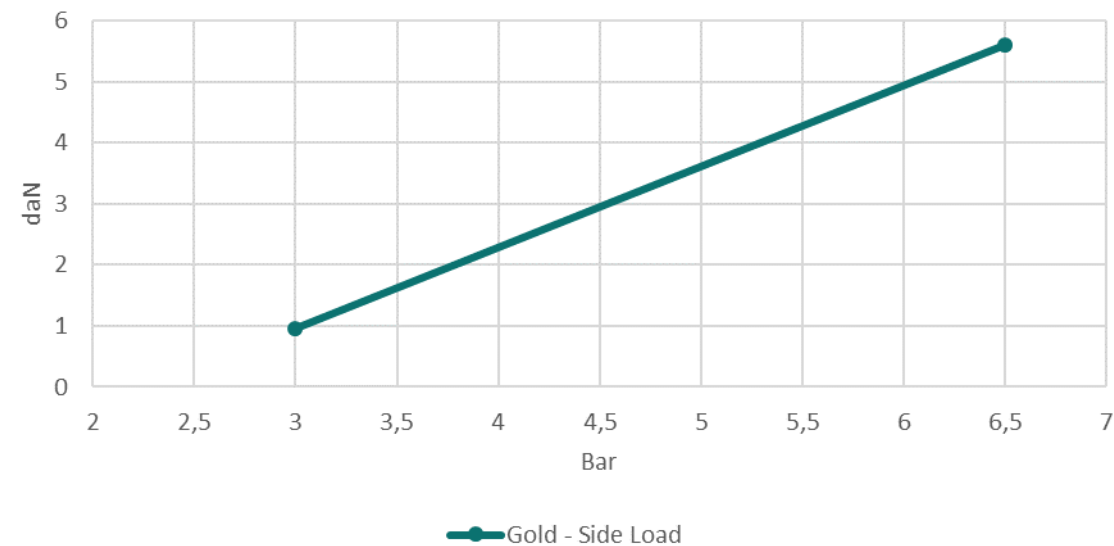

Gold develops 5,6 daN of side load at 6,5 Bar.

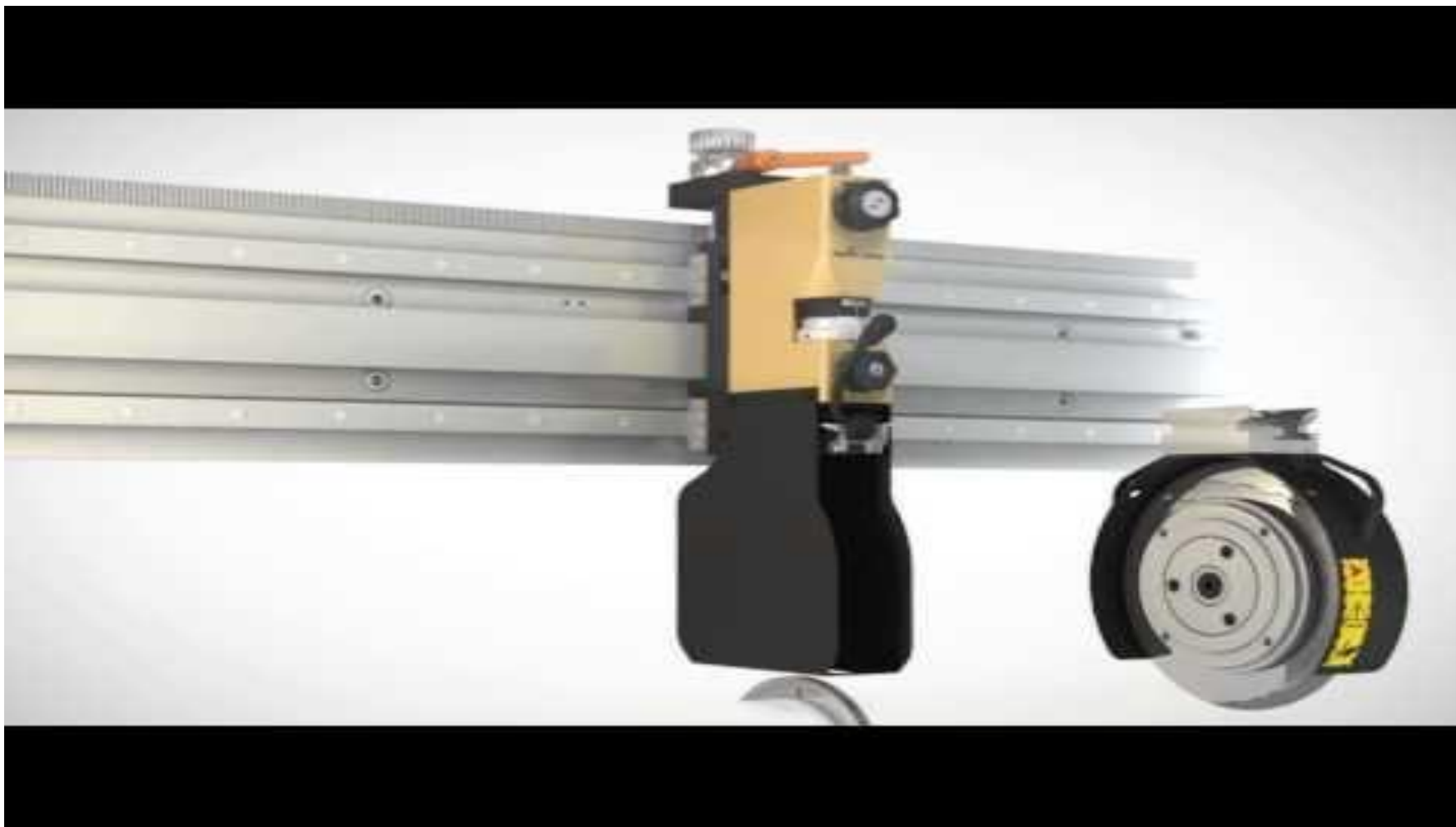

Video Link:



<https://youtu.be/Zq9TKLCBIEY>

For further information:

Mario Cotta – Zincometal S.p.A.

C.so Europa 87, 20010 Inveruno (MI)

Tel. +39 02 979 661

Email: sales@mariocotta.com

www.mariocotta.com